

VEYA 53 | 2025



VEYA





**At Veya, we believe life should be lived. Fully.
No compromises. No limits.**

Our power catamarans combine space, rugged strength
with refined design.

Crafted to enrich your journey offering durability,
freedom, and togetherness for every adventure.

After all, it's not just about where you go, it's
about who you go with, how you go, and
how you feel along the way.

Welcome in the world of Veya.



We invite you to embrace a life of limitless exploration. Our power catamarans are designed to provide expansive, thoughtfully crafted spaces that elevate comfort and inspire endless possibilities. Veya perfectly blends style with functionality to create elegant, enduring experiences.



Our commitment to quality ensures lasting value, combining durability, practicality, and affordability. Every innovation we introduce has one purpose: to simplify your life at sea.

With Veya, there's always room for adventure.

An aerial photograph of a tropical beach. The left side of the image shows clear, turquoise water with some darker patches of coral or rocks visible beneath the surface. A white sandy beach runs diagonally from the top right towards the bottom right. On the right side of the beach, several palm trees are visible, their fronds casting shadows on the sand. The overall scene is bright and sunny, with a warm, golden light.

ROOM FOR ADVENTURE



DISCOVER
THE NEW

V53

The premium yacht
that balances comfort, lifestyle
and the spirit of adventure.



VEYA

Expansive views.
Effortless comfort.
Endless freedom.



Spacious foredeck salon

Enjoy ocean panoramas from sunbeds, easy foredeck access, and an adaptable shade system for effortless relaxation.



v53

VEYA



v53

A large living space facing the ocean.



Aft cockpit

Bifolding glass doors blend indoor comfort with outdoor relaxation, while a choice of layouts suits your lifestyle. The aft diner cockpit seats eight plus two benches with a bar, while the open aft lounge layout maximizes space and ocean access.



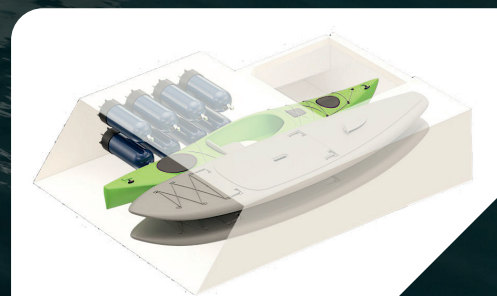

V53

Ready for nautical adventures. Design for ease.



Hydraulic platform

The hydraulic platform doubles as a tender lift and aft beach, offering a seamless transition from sea to deck. It enhances your onboard experience with effortless water access and relaxation. Additionally, it provides direct access to the lazarette, ensuring convenient and secure storage for water toys and gear.



Explore new horizons.

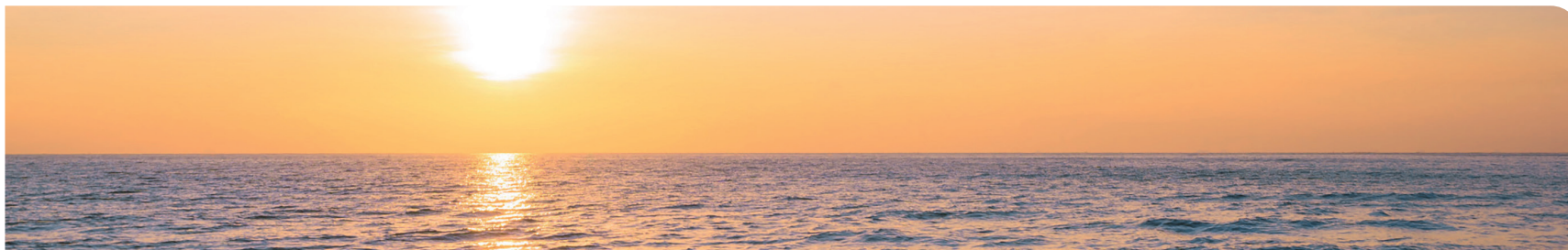

The flybridge

The large helm station features comfortable seating beside a comfortable lounge, to enjoy the journey. A summer kitchen complements the spacious dining area, all surrounded by stunning 360° views.





v53

VEYA



V53

Refined comfort overlooking great landscapes.



The saloon

The dining area is spacious with a high ceiling, giving it an open and welcoming feel. The interior helm station provides easy navigation, and the kitchen connects smoothly to the aft cockpit. With quality materials and elegant finishes, this space feels both stylish and comfortable.

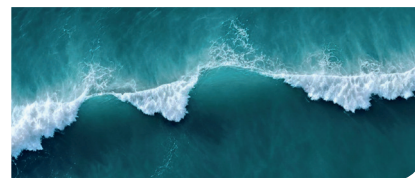

A Private Sanctuary. Immersed in Nature.



Owner cabin

The owner's cabin offers panoramic ocean views, premium materials, and smart storage. An elegant en-suite bathroom provides privacy and relaxation. It's the perfect space to unwind and recharge.



v53

VEYA



V53

Technical Specifications

Overall length	16.50 m	54'1"
Length waterline	15.50 m	50'1"
Overall beam	7.96 m	26'1"
Draft	1.1 m	3'7"
Light displacement	27300 Kg	60186 lbs
Fully loaded displacement	35682 Kg	78665 lbs
Max guests	8+2 crew	

Engines

2x Yanmar 6LY 440 - V Drive Shaft

Upgrade: 2x Yanmar 6LF 550 - V Drive Shaft

Tankage

Water Tanks	2*350L	184 Gal
Fuel Tanks	2*1000L	2*264 Gal
Optional extra Fuel Tanks	2*400L	2*105 Gal
Optional Grey Water	2*175L	2*46 Gal
Holding Tank	250L	66 Gal
Hot water	80L	21 Gal

Construction

Foam Core Sandwich Infusion

Builder

Couach Catamarans

Design and Styling

Berret Racoupeau

Certification

Cat A - Ocean Waters	11 PAX
Cat B - Offshore Waters	11 PAX
Cat C - Coastal Waters	20 PAX
Cat D - Sheltered Coastal Waters	35 PAX

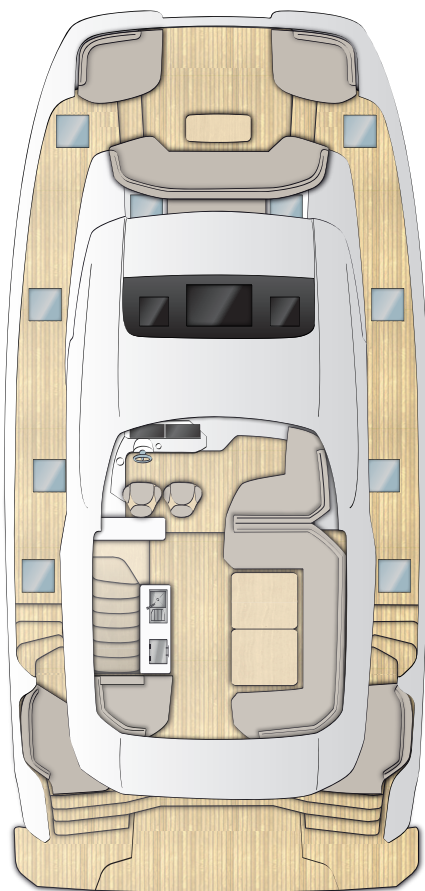

Flybridge

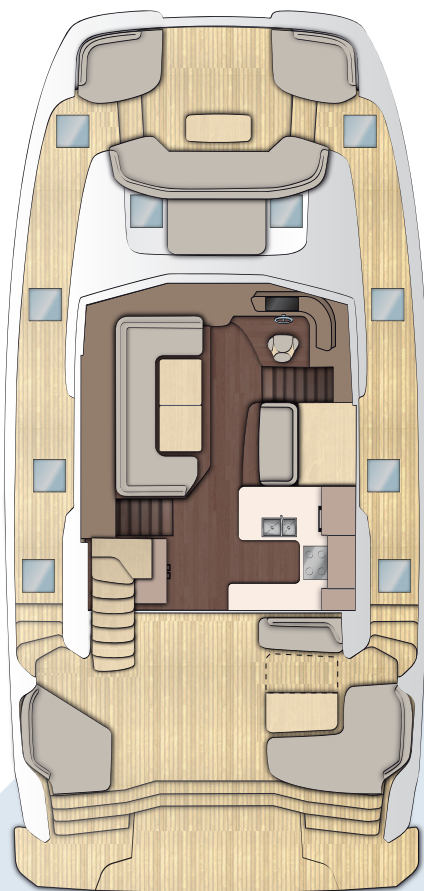

3 cabins version
with standard aft lounge cockpit

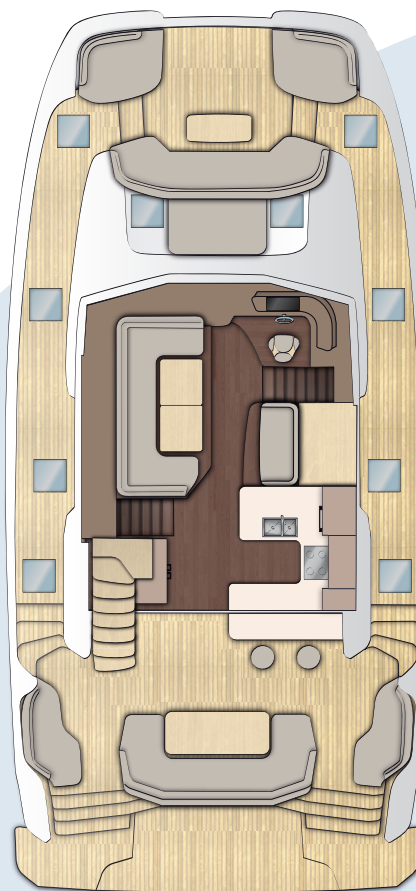

3 cabins version
with optional aft deck layout

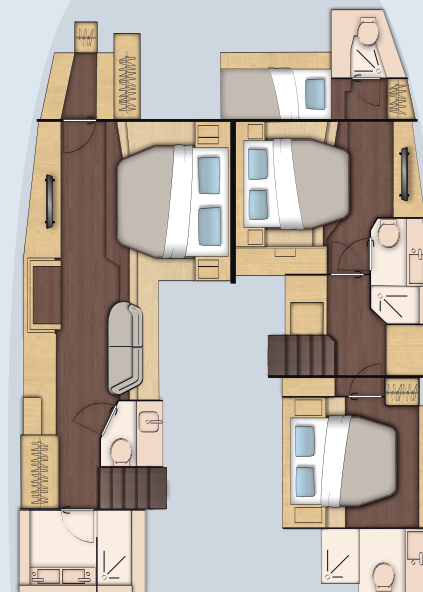

3 cabins version
with optional 1 crew cabin

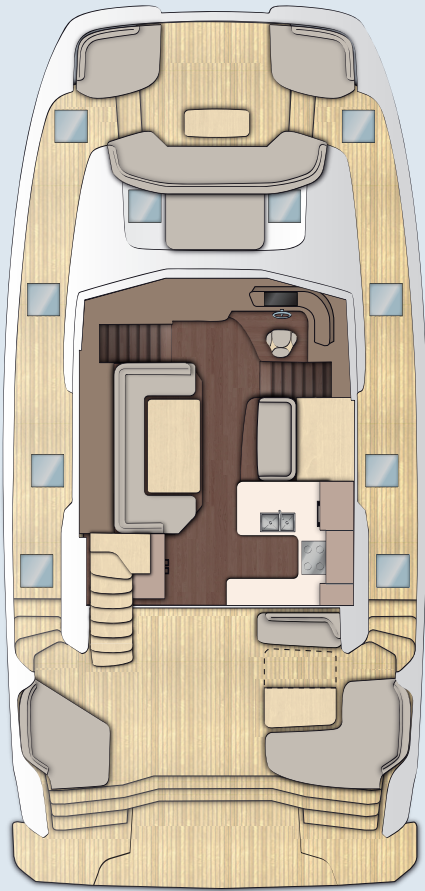

4 cabins version
with standard aft lounge cockpit

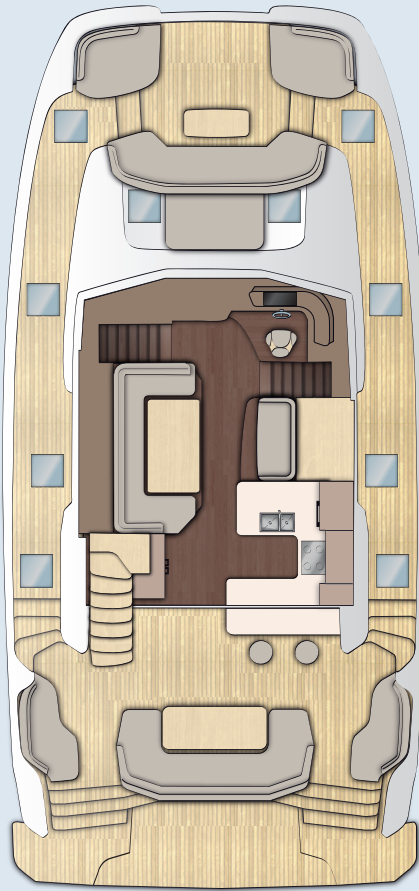

4 cabins version
with optional aft dining cockpit

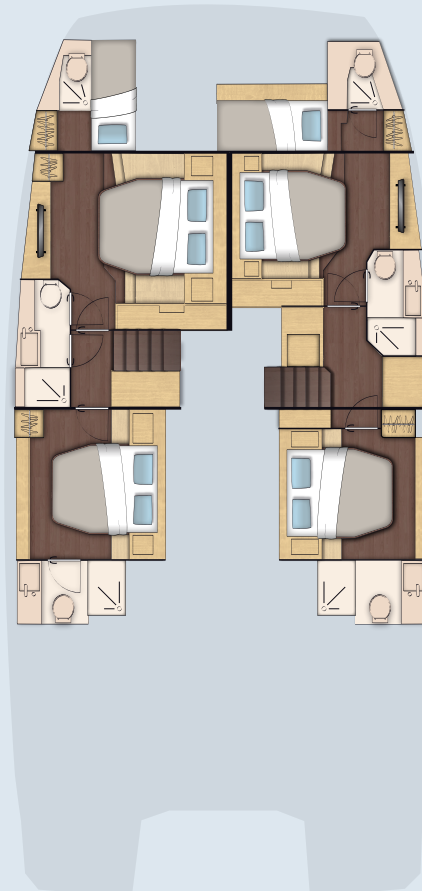

4 cabins version
with optional 2 crew cabins

Veya 53 layout



[VEYA-YACHTS.COM](https://veya-yachts.com)

contact@veya-yachts.com

10 Rue de l'Yser | 33470 Gujan-Mestras | France



Specifications, features, and layouts are subject to change at the manufacturer's discretion without prior notice.
Performance figures, including speed, are indicative only and not contractual.
Images and descriptions are for illustrative purposes only and may not reflect the final product.